

SR575E



Mounting Pattern
200 x 200 up to
600 x 400mm



Max Load
150lb (68.2kg)
display

SMARTMOUNT.

Flat Panel Video Conferencing Cart

FOR 32" TO 75" DISPLAY

The SR575E SmartMount® Video Conferencing Cart offers an array of features perfect for any setting where telecommunication is required. The mobility of the cart eliminates the need for multiple video conference systems, lowering your overall system cost. The structure is optimized to hold one 32"-75" display, providing clear visibility for all participants. The camera can be located directly above the display, for near perfect eye contact during your meetings. A lockable storage area houses all components inside the enclosure and the upper door doubles as a laptop with a display sized workstation when needed.

- Integrated cable management protects, contains and conceals cables for a clean, professional installation
- Textured black powder coat finish helps to hide finger prints and dust while stainless steel accents provide an attractive appearance
- Upright structure houses components in either 2RU 19" rack mount configuration or a shelf inside the lockable compartment
- 6 Outlet surge protector with 15ft cord housed inside the enclosure
- Upper compartment doubles as a work surface for laptops or keyboard/mouse and test monitor
- Universal display adaptor fits mounting patterns from 200 x 200mm to 600 x 400mm and allows mounting in landscape or portrait orientation

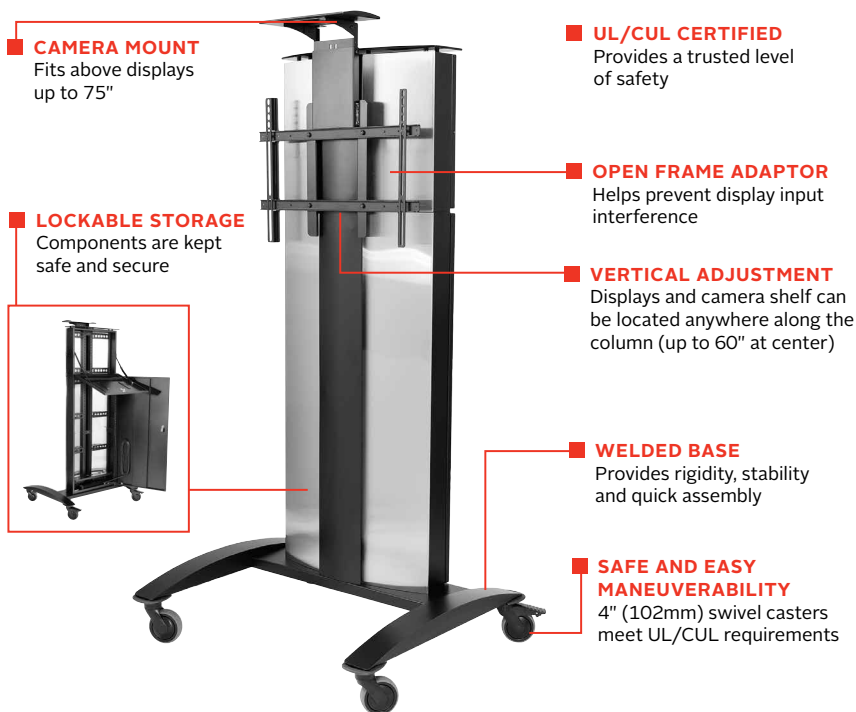

(2) 2RU rack mount locations provide ample space for rack mountable components



Locking upper door provides ideal work surface when open and secured storage when closed



Corner bumpers protect walls and doorways from damage



SR575E SmartMount® Flat Panel Video Conferencing Cart for 32" to 75" Display

Product Specifications

	DIMENSIONS (W X H X D)	PRODUCT WEIGHT	LOAD CAPACITY	FINISH	AVAILABLE COLORS
SR575E	35.01" x 78.10" x 29.00" (889 x 1983 x 737mm)	163lb (74.1kg)	150lb (68.2kg) display	Textured Powder Coat	Black with Brushed Stainless Steel Front

Package Specifications

	PACKAGE SIZE (W x H x D)	PACKAGE SHIP WEIGHT	PACKAGE UPC CODE	PACKAGE CONTENTS	UNITS IN PACKAGE
SR575E	46.00" X 38.00" X 24.00" (1168 x 965 x 610mm)	178lb (80.9kg)	735029305064	Assembled Base, Lower Storage Encloser, Upper Storage Enclosure, Universal Display Adaptor, Camera Shelf, (2) Swivel Casters, (2) Locking Swivel Casters, (4) Base Bumpers, Hardware & Instructions	1

Accessories

ACC310: Feet Accessory
ACC316: Safety Belt
ACC-UCM: Universal AV Component Mount

All dimensions = inch (mm)

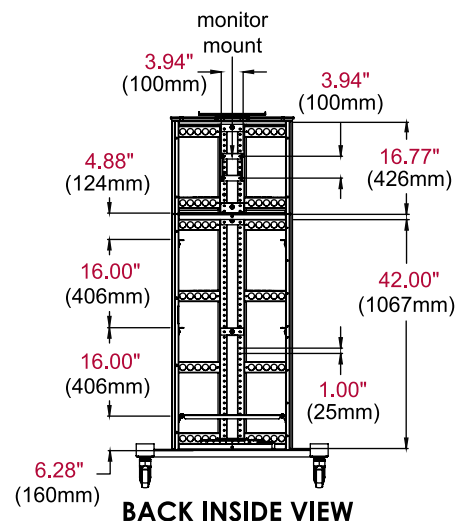
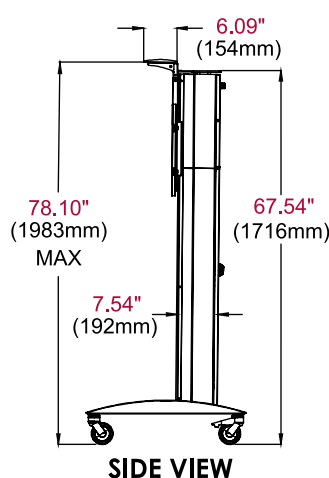
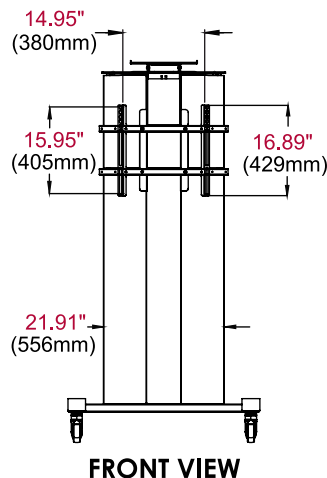
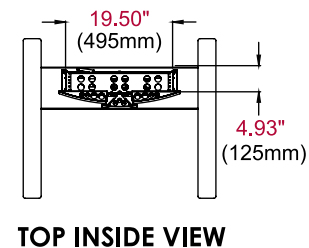
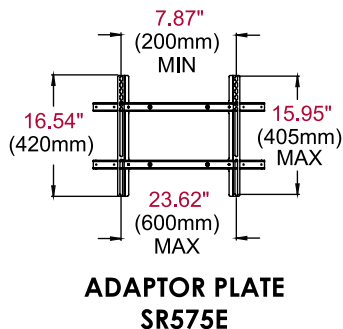
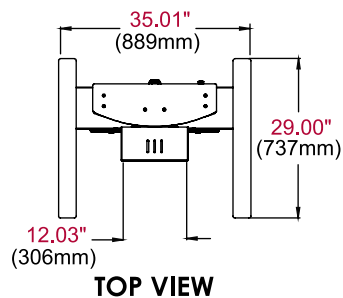

Architect Specifications

The SmartMount® Flat Panel Video Conferencing Cart shall be a Peerless-AV model SR575E and shall be located where indicated on the plans.. Assembly and installation shall be done according to instructions provided by the manufacturer.

Visit peerless-av.com to see the complete line of AV solutions from Peerless-AV, including outdoor displays, wireless, kiosks, digital audio, display mounts, projector mounts, carts/stands, and a full assortment of accessories.

Peerless-AV
 2300 White Oak Circle
 Aurora, IL 60502 USA
(800) 865-2112
(630) 375-5100
Fax: (800) 359-6500

Peerless-AV EMEA
 Unit 3 Watford Interchange
 Colonial Way, Watford
 Herts, WD24 4WP
 United Kingdom
+44 (0) 1923 200100
Fax: +44 (0) 1923 200101

Peerless-AV Latin America
 Av. de las Industrias 413
 Parque Industrial Escobedo
 General Escobedo, N.L.,
 México, 66062
+52 (81) 8384-8300
Fax: +52 (81) 8384-8360

peerless-AV®
 Driving Technology Through Innovation

LIT-1255 rev.4